

Technical Information for 420, 425, 620, 625, 13270 & 13275 Series

STAINLESS STEEL QUICK RELEASE FASTENERS FOR FAST ASSEMBLY

ACTION

Locking - The pins locked in position when the balls a and b are protruding from the external diameter ($\varnothing A$) of the pin.

Unlocking - The pins are unlocked when the balls a and b are retracted within the outer diameter ($\varnothing A$) of the pin.

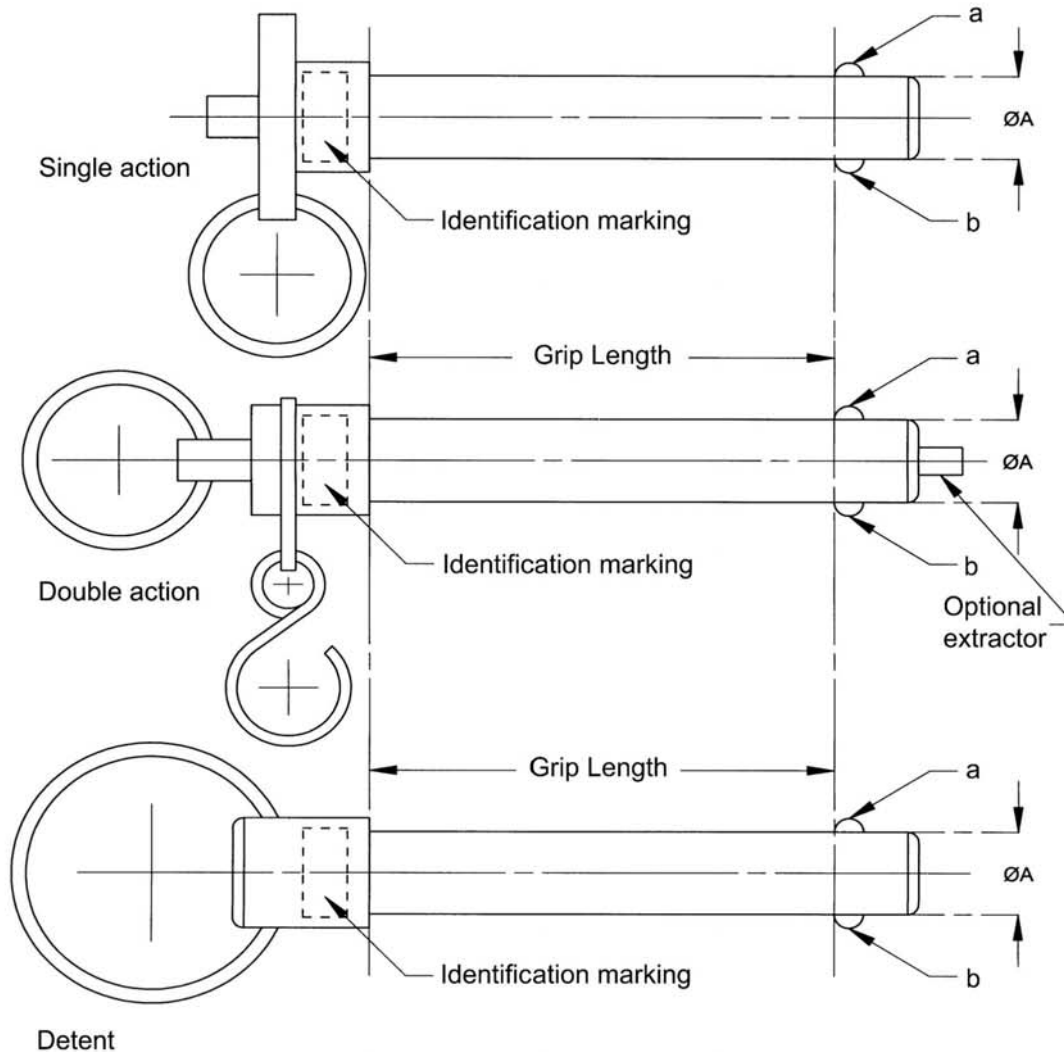

Technical Information Cont'd

Please note that the technical information relates to the following pins only:
420, 425, 620, 625, 13270 and 13275 series.

Type of pin	Reference Versions Dimensions		Stainless Steel	Systems	
	Metric	Inch		Locking Balls a and b are retained in position	Unlocking Balls a and b are retracted
Single action	620	625	Material AISI 431 heat treated	By a plunger retained by a spring	By pushing the button
Double action	13270	13275			By pushing or pulling the button
Detent	420	425		By a silicone pellet	By pulling the pin

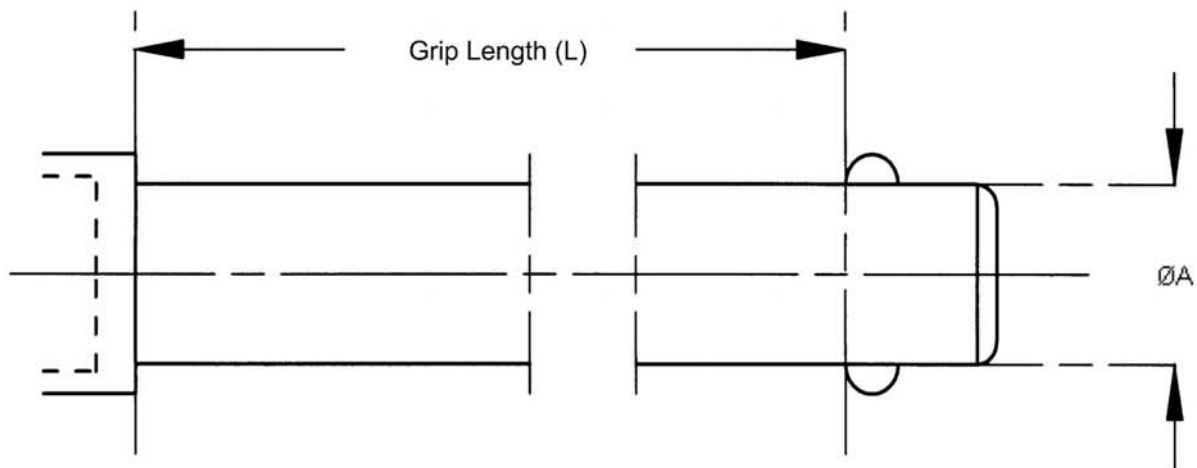

ØA DIMENSIONS	
Metric (mm)	Imperial (inch)
6 - 8 - 10 - 12 - 14 - 18 - 20 - 22 - 24 - 25	3/16 - 1/4 - 5/16 - 3/8 - 7/16 - 1/2 - 9/16 - 5/8 - 3/4 - 7/8 - 1
L in mm (tol: +0.5 - 0.0)	L in inches: (tol: +0.020 - 0.000)

Note: The diameters and lengths shown are the more popular sizes, larger diameters and designs to suit special applications are available. Please call the sales office to discuss your requirements.

T: + 44 (0)1803 868677 • F: + 44 (0)1803 868678

E: sales@specialty-fasteners.co.uk

W: www.specialty-fasteners.co.uk

**SPECIALTY
FASTENERS &
COMPONENTS LTD** 