



# Gas Springs Stainless Connectors



Stainless Steel Ball Joints

SFC offer a wide range of stainless steel end connectors that will enhance your application. Manufactured from a range of materials including nylon, and stainless steel they will give many years of trouble free operation.

End fittings or end connectors can be both the same or you can choose different sizes and types for each end. Flexibility is what SFC offers you.

	<b>G1 (B2 Equivalent)</b>	<b>G5 (B4 Equivalent)</b>
J (+/-)	12.0mm 0.3mm	13.0mm 0.3mm
K (+/-)	12.5mm 0.3mm	16.5mm 0.3mm
G	M8 x 1.25	M8 x 1.25
L (+/-)	18.0mm 0.3mm	30.0mm 0.3mm
C	M6 x 1.0	M8 x 1.25

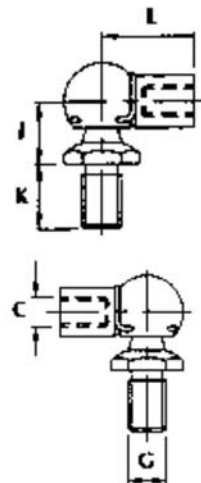

All Nylon Ball Joints – Stainless Steel Pins

	<b>PE</b>	<b>PV</b>	<b>PW</b>
J (+/-)	9.0mm 0.25mm	12.0mm 0.25mm	NO PIN
K (+/-)	10.3mm 0.25mm	12.5mm 0.5mm	NO PIN
G	M5 x 0.8	M8 x 1.25	NO PIN
C	M5 x 0.8	M6 x 1.0	M6 x 1.0
L (+/-)	17.5mm 0.5mm	18.0mm 0.25mm	18.0mm 0.25mm

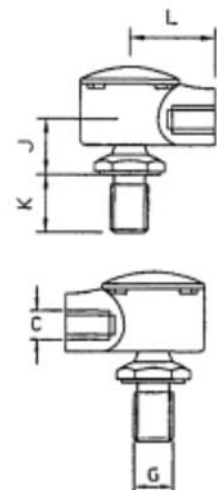

# Gas Springs Stainless Connectors



## Nylon Eyes

	E1	E2	E3	E4	E5
E (+/-)	6.1mm 0.08mm	7.35mm 0.05mm	8.1mm 0.05mm	6.1mm 0.05mm	10.1mm 0.05mm
M (+/-)	8.1mm 0.05mm	7.0mm 0.2mm	10.0mm 0.12mm	10.0mm 0.12mm	10.0mm 0.12mm
L (+/-)	17.0mm 0.5mm	17.0mm 0.5mm	21.0mm 0.25mm	21.0mm 0.25mm	21.0mm 0.25mm
C	M5 x 0.8	M5 x 0.8	M6 x 1.0	M6 x 1.0	M6 x 1.0

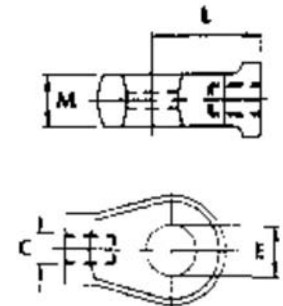

## Stainless Steel Flat Eyes

	J1	J2
E (+/-)	8.0mm 0.036mm/-0.00	8.0mm 0.036mm/-0.00
M (+/-)	5.12mm 0.12mm	8.12mm 0.12mm
L (+/-)	25.0mm 0.25mm	32.0mm 0.25mm
C	M6 x 1.0	M8 x 1.25

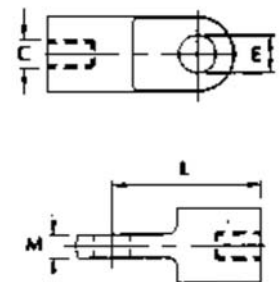

## Stainless Steel Clevis Forks

	H1	H2
E (+/-)	6.0mm 0.036mm/-0.00	8.0mm 0.036mm/-0.00
M (+/-)	6.25mm +/-0.10mm	8.27mm 0.12mm
L (+/-)	24.0mm 0.25mm	32.0mm 0.25mm
C	M6 x 1.0	M8 x 1.25

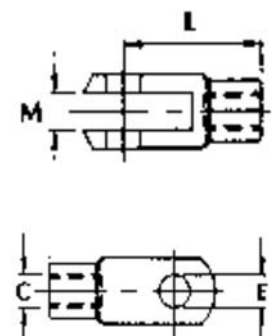

T: + 44 (0)1803 868677 • F: + 44 (0)1803 868678

E: sales@specialty-fasteners.co.uk

W: www.specialty-fasteners.co.uk

**SPECIALTY  
FASTENERS &  
COMPONENTS LTD**



54 GS

5

Gas Springs