



# Detent Clevis Pins and Lynch Pins



MADE TO  
ORDER



Ball tension can be modified  
to create holding force required

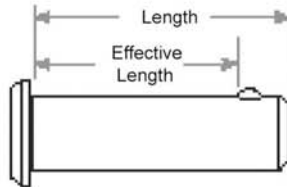

## Detent Clevis Pins

Ball detent depresses and springs up to hold clevis pin in place. Used for assembly speed or hard-to-cotter applications. This fastener lowers labor costs and offers quick release features for flush-mount applications.

Made to order, detent clevis pins are based on standard clevis pin head and shank dimensions.

Ends are pointed for easy insertion. Pins are typically zinc plated carbon steel and the ball detent is stainless type 302.

Ball compression force can be adjusted at time of manufacture to meet force required to insert and remove. All parts are subject to rigid quality control procedures for long life service.

## Lynch Pins

Made to rigid standards, this is the highest quality standard lynch pin available.

Made from low carbon steel, zinc plated and yellow chromate dipped, this pin is especially corrosion resistant. Ring is made from hard drawn MB spring wire. The "over center" ring loop attached to the head snaps down hard to hold the fastener in place. A special heavy duty ring is also available for extreme applications.

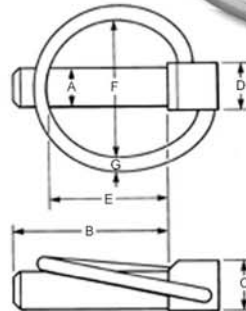

### Lynch Pins - Zinc with Yellow Chromate

Part No.	A Pin Diameter	B Shank Length	Approximate Nominal Divisions				G Wire Diameter	Approx. Weight/ Pounds per 100 pieces
			C Head Height	D Head Width	E Capture Length	F Ring Width		
HANG-1	3/16	1-1/4	1/2	11/32	1	1-1/8	.109	3.2
HANG-2	3/16	1-9/16	1/2	11/32	1-5/16	1-7/16	.138	4.4
HANG-4	1/4	1-3/4	1/2	11/32	1-5/16	1-7/16	.138	5.5
HANG-6	5/16	1-3/4	1/2	13/32	1-3/8	1-1/2	.138	7.0
HANG-8	7/16	1-3/4	9/16	7/16	1-3/8	1-1/2	.138	10.8
HANG-8L	7/16	1-15/16	19/32	1/2	1-11/16	1-7/8	.138	12.0
HANG-8HD*	7/16	1-15/16	19/32	1/2	1-1/2	1-21/32	.193	14.2

\* Zinc plated pin with clear chromate (bright) black oxide ring.  
Unless otherwise noted, all dimensions are for reference only.