

CAMS FOR USE WITH RODS

- * For use with UM1268 & UM1033 latches (90° rotation)
- * 'L' dimension = 45mm, other lengths are available on request
- * Special cams can be produced to customer requirements
- * Material: Steel, Zinc or Nitrotec™ finished

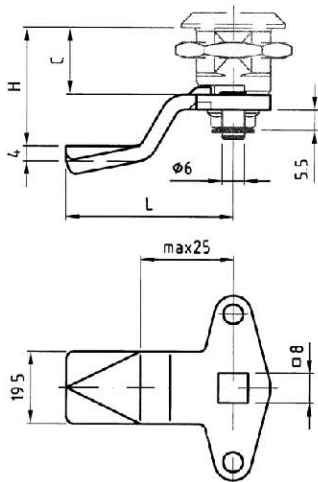

NYLOC NUT FIXING
Threaded stud fixed with nyloc nut

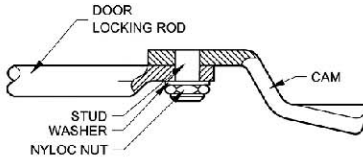

With Projected Stop

H' Dim.	Part Number		
	C=18	C=22	C=30
4	UM1495-14		
6	UM1495-12		
8	UM1495-10	UM1495-14	
10	UM1495-08	UM1495-12	
12	UM1495-06	UM1495-10	
13	UM1495-07	UM1495-09	
14	UM1495-04	UM1495-08	
16	UM1495-02	UM1495-06	UM1495-14
18	UM1495-00	UM1495-04	UM1495-12
20	UM1495+02	UM1495-02	UM1495-10
22	UM1495+04	UM1495-00	UM1495-08
24	UM1495+06	UM1495+02	UM1495-06
25	UM1495+07	UM1495+03	UM1495-05
26	UM1495+08	UM1495+04	UM1495-04
28	UM1495+10	UM1495+06	UM1495-02
30	UM1495+12	UM1495+08	UM1495-00
31	UM1495+13	UM1495+09	UM1495+01
32	UM1495+14	UM1495+10	UM1495+02
34	UM1495+16	UM1495+12	UM1495+04
35	UM1495+17	UM1495+13	UM1495+05
36	UM1495+18	UM1495+14	UM1495+06
37	UM1495+19	UM1495+15	UM1495+07
38	UM1495+20	UM1495+16	UM1495+08
40	UM1495+22	UM1495+18	UM1495+10
42	UM1495+24	UM1495+20	UM1495+12
43	UM1495+25	UM1495+21	UM1495+13
44	UM1495+26	UM1495+22	UM1495+14
45	UM1495+27	UM1495+23	UM1495+15
46	UM1495+28	UM1495+24	UM1495+16
47	UM1495+29	UM1495+25	UM1495+17
48	UM1495+30	UM1495+26	UM1495+18
50	UM1495+32	UM1495+28	UM1495+20
52		UM1495+30	UM1495+22
53		UM1495+31	UM1495+23
54		UM1495+32	UM1495+24
55			UM1495+25
56			UM1495+26
57			UM1495+27
58			UM1495+28
59			UM1495+29
60			UM1495+30
62			UM1495+32

Without Projected Stop

H' Dim.	Part Number		
	C=18	C=22	C=30
4	UM1490-14		
6	UM1490-12		
8	UM1490-10	UM1490-14	
10	UM1490-08	UM1490-12	
12	UM1490-06	UM1490-10	
13	UM1490-07	UM1490-09	
14	UM1490-04	UM1490-08	
16	UM1490-02	UM1490-06	UM1490-14
18	UM1490-00	UM1490-04	UM1490-12
20	UM1490+02	UM1490-02	UM1490-10
22	UM1490+04	UM1490-00	UM1490-08
24	UM1490+06	UM1490+02	UM1490-06
25	UM1490+07	UM1490+03	UM1490-05
26	UM1490+08	UM1490+04	UM1490-04
28	UM1490+10	UM1490+06	UM1490-02
30	UM1490+12	UM1490+08	UM1490-00
31	UM1490+13	UM1490+09	UM1490+01
32	UM1490+14	UM1490+10	UM1490+02
34	UM1490+16	UM1490+12	UM1490+04
35	UM1490+17	UM1490+13	UM1490+05
36	UM1490+18	UM1490+14	UM1490+06
37	UM1490+19	UM1490+15	UM1490+07
38	UM1490+20	UM1490+16	UM1490+08
40	UM1490+22	UM1490+18	UM1490+10
42	UM1490+24	UM1490+20	UM1490+12
43	UM1490+25	UM1490+21	UM1490+13
44	UM1490+26	UM1490+22	UM1490+14
45	UM1490+27	UM1490+23	UM1490+15
46	UM1490+28	UM1490+24	UM1490+16
47	UM1490+29	UM1490+25	UM1490+17
48	UM1490+30	UM1490+26	UM1490+18
50	UM1490+32	UM1490+28	UM1490+20
52		UM1490+30	UM1490+22
53		UM1490+31	UM1490+23
54		UM1490+32	UM1490+24
55			UM1490+25
56			UM1490+26
57			UM1490+27
58			UM1490+28
59			UM1490+29
60			UM1490+30
62			UM1490+32

Note: Supplied zinc plated, suffix part number with 'N' for Nitrotec finish

For different 'C' dimensions, please contact the Sales Office with the values of 'C' & 'L' or use the formula opposite to create a part number enquiry.

Part Number Formula

U	M	1	4	9	X	X	X	X	-X
---	---	---	---	---	---	---	---	---	----

0 - with projected stop
 5 - without projected stop
 ± - positive or negative offset
 Offset distance (H-C)

Example:

C=18mm, H=22mm

without projected stop

Part Number becomes

UM1495+04